

To Sanction Room (A) Plan
scale 1:50

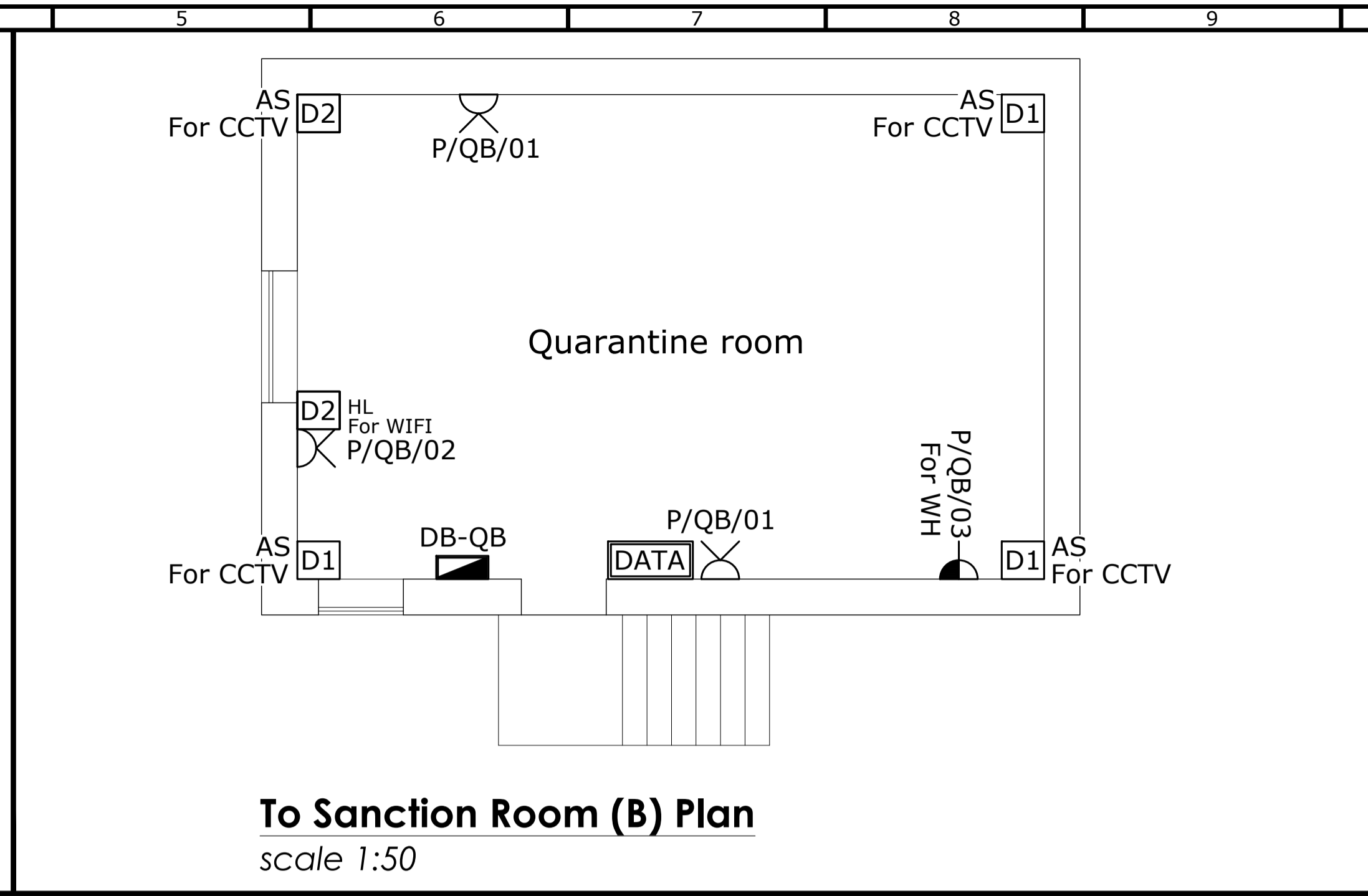

To Sanction Room (B) Plan
scale 1:50

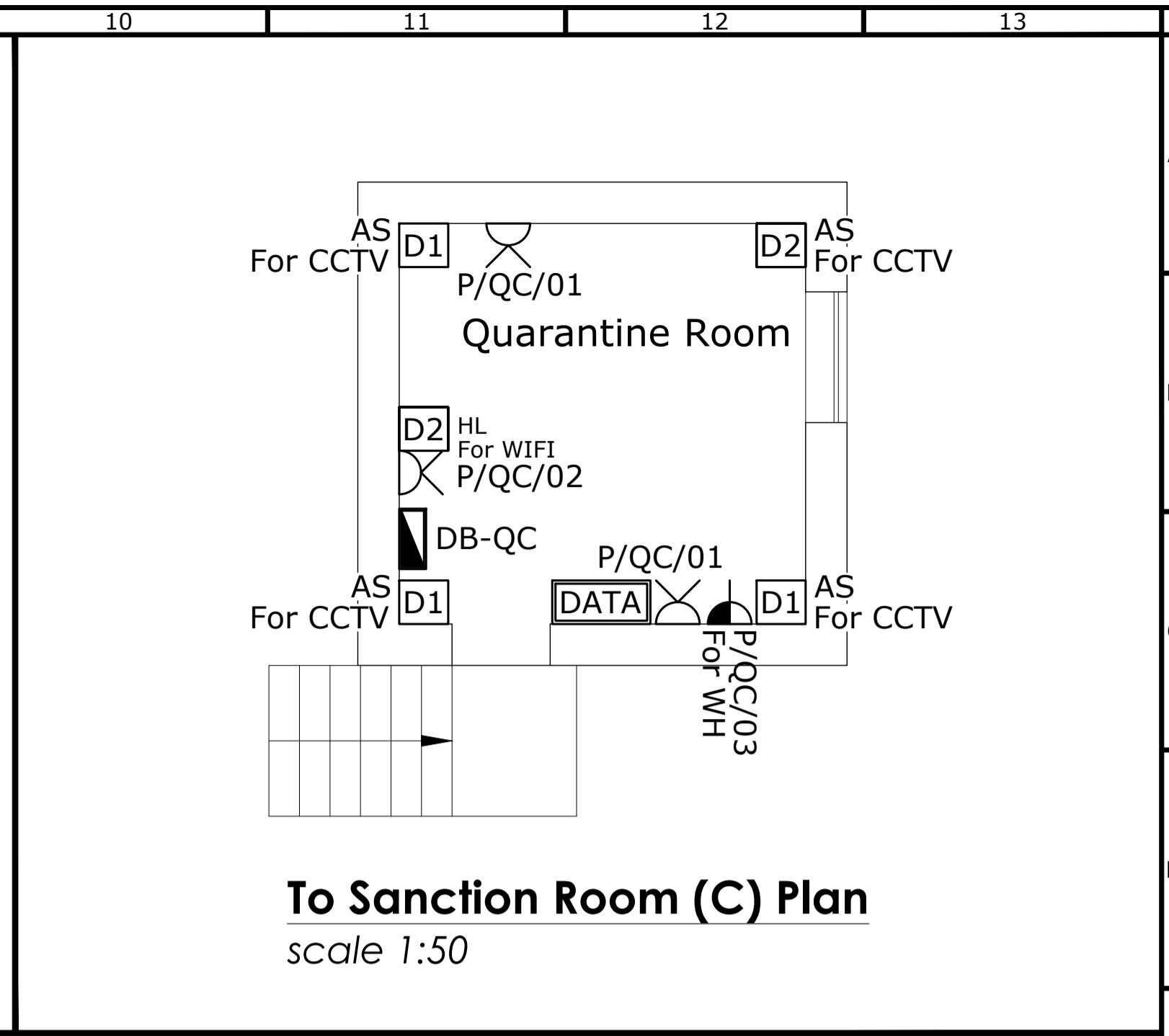

To Sanction Room (C) Plan
scale 1:50

General Notes and Legends

Legend:

- Single Socket Outlet
- Twin Socket Outlet
- Double Pole Switch
- 1φ Isolator
- 3φ Isolator
- 16A 1φ Industrial Socket Outlet
- 32A 3φ Industrial Socket Outlet
- Data Point x1
- Data Point x2
- Distribution Board / Consumer Unit
- Ventilation Control Panel
- Floor Box # (Detail)
- Main Tank Controller

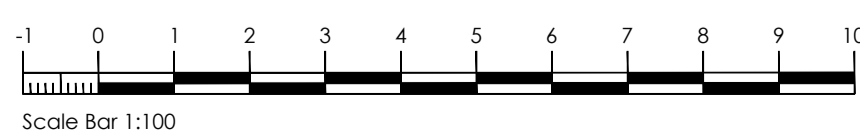
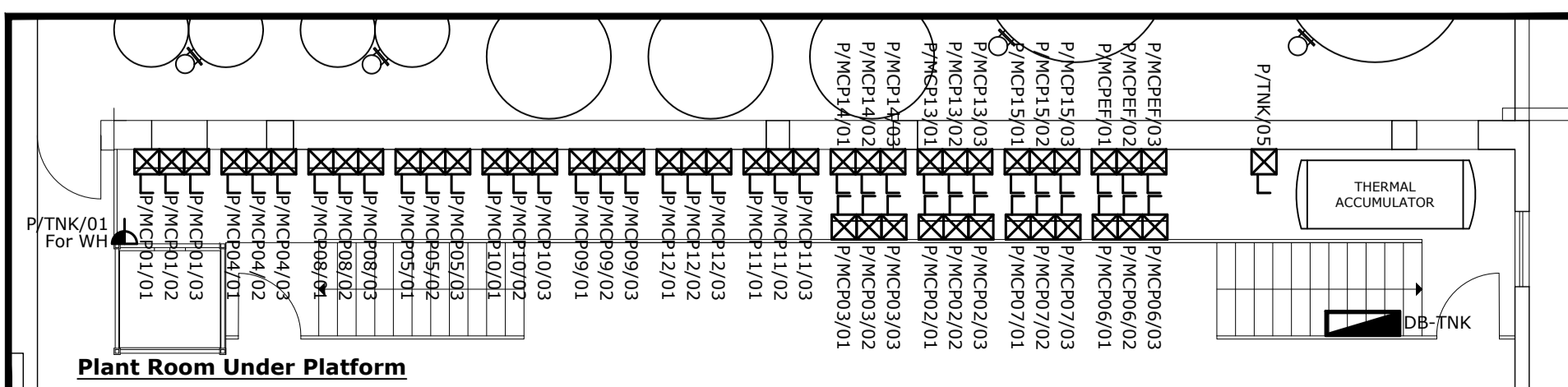
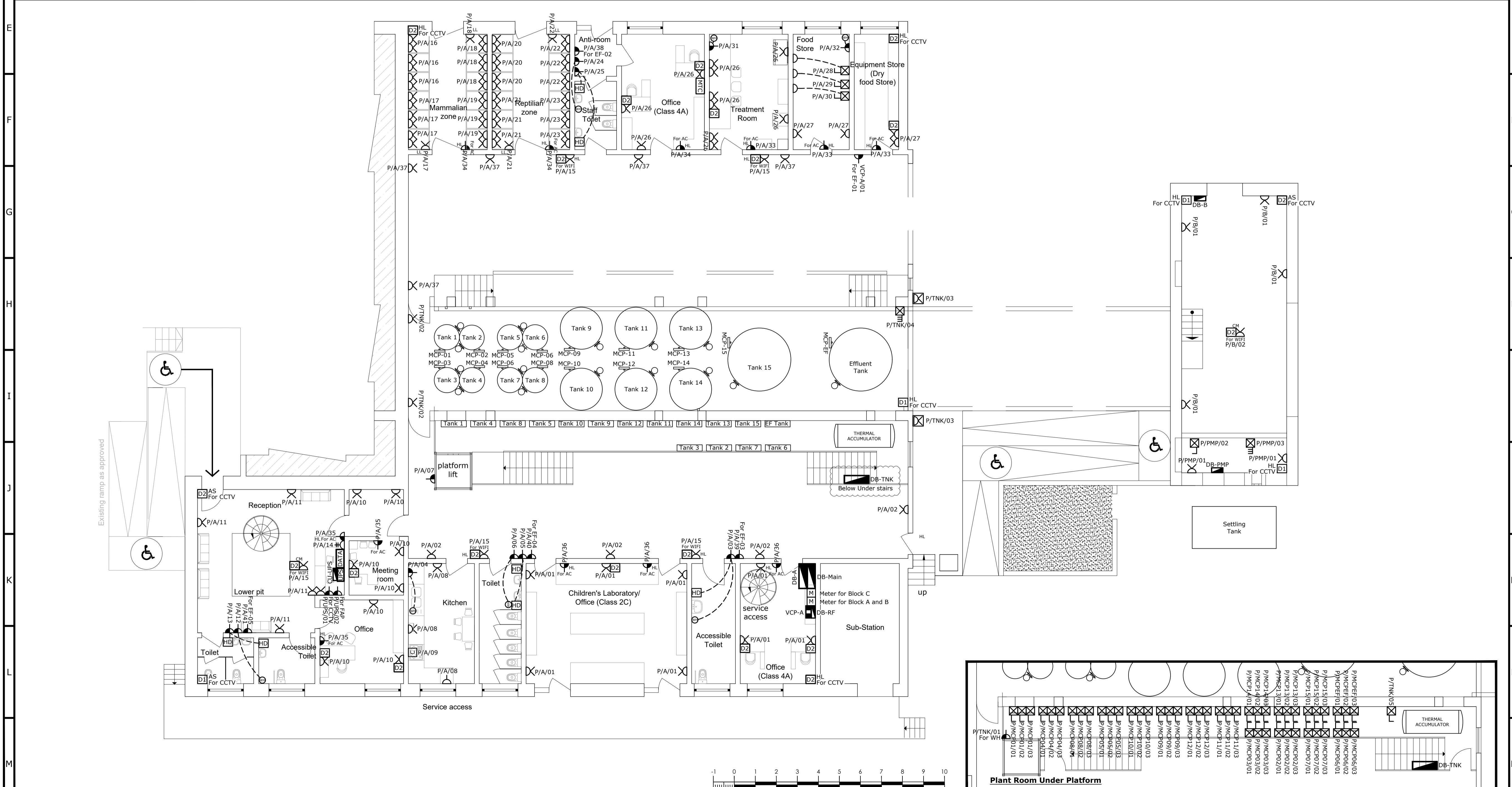

A1 PLEASE DO NOT SCALE FROM THE DRAWING

02	23.09.20	Rev	Revised Layout
01	14.09.20	Rev	Revised Layout

CAMILLERI & CUSCHIERI
CONSULTING ENGINEERS

Design Center, Level 2, Tower Road, Swatara,
Birkirkara, Malta - BKA 4012
+356 21220431
info@camillerianduscieri.com
www.camillerianduscieri.com

40 Years

Project Name & Address:
Nature Trust
Xrobb L-Ghagin

THIS DRAWING IS CONFIDENTIAL AND IS THE PROPERTY OF CAMILLERI & CUSCHIERI CONSULTING ENGINEERS. IT MUST NOT BE DISCLOSED TO A THIRD PARTY, COPIED OR LENT, WITHOUT THE WRITTEN CONSENT OF CAMILLERI & CUSCHIERI CONSULTING ENGINEERS.

Scale:	1:100	Revision No.:	02	Date:	24.08.20
Job No.:	20.032	Drawing No.:	NT-XG.PWR.01.01		
Drawn By:	<i>Nayana Abida</i>	Checked By:			
Position:	Ground Floor				
Service:	Power Installation Layout				