

To Sanction Room (A) Plan
scale 1:50

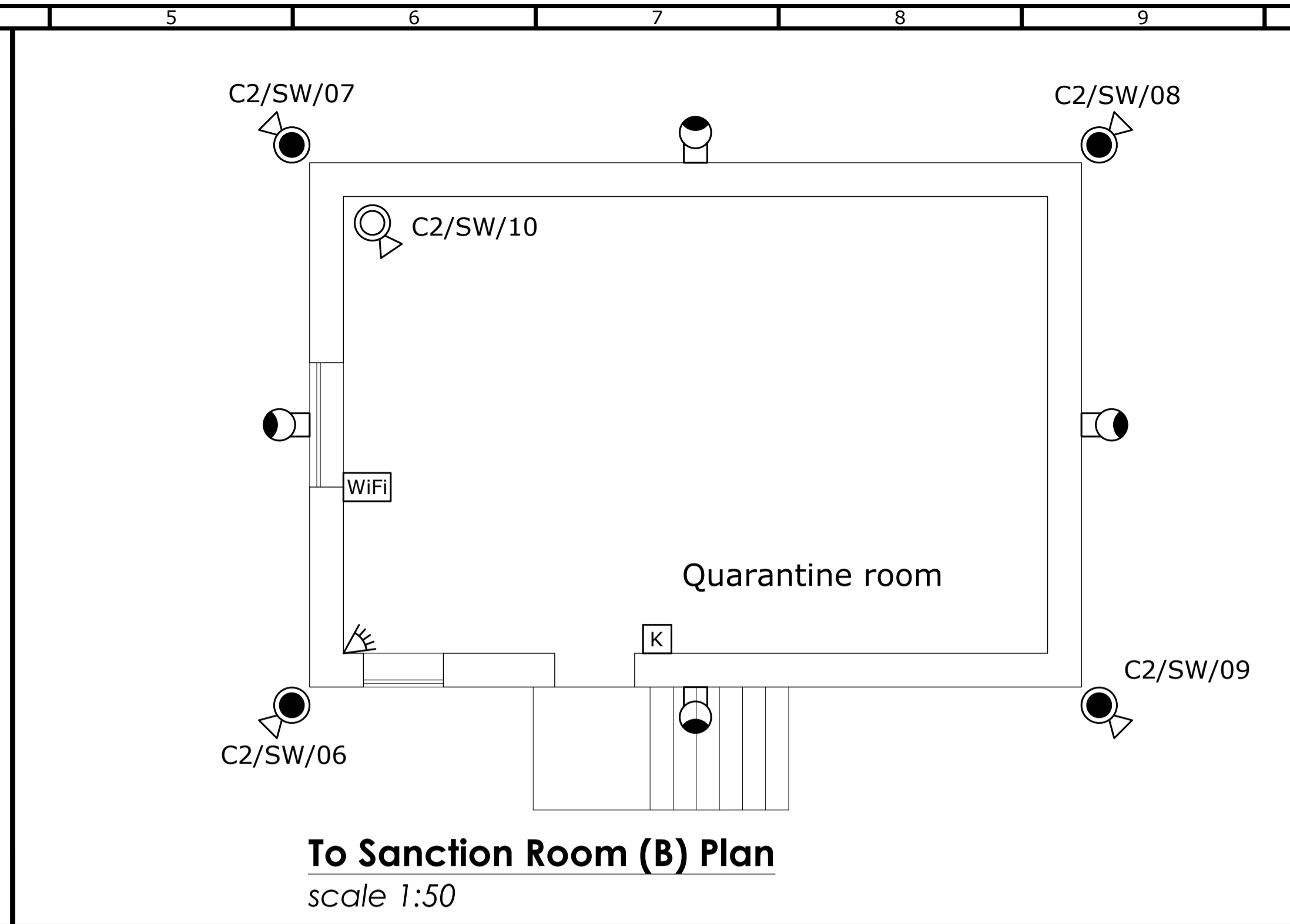

To Sanction Room (B) Plan
scale 1:50

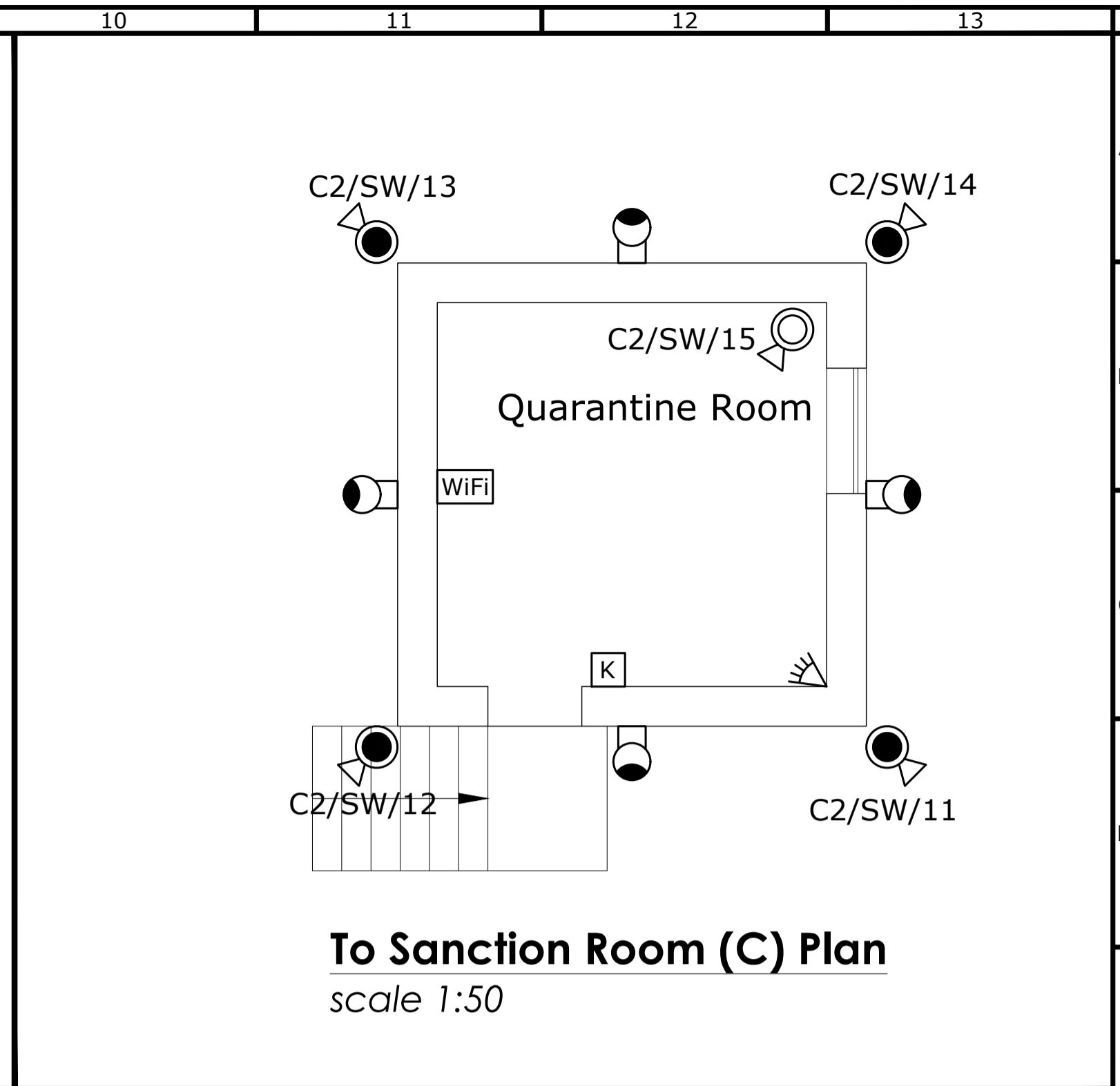

To Sanction Room (C) Plan
scale 1:50

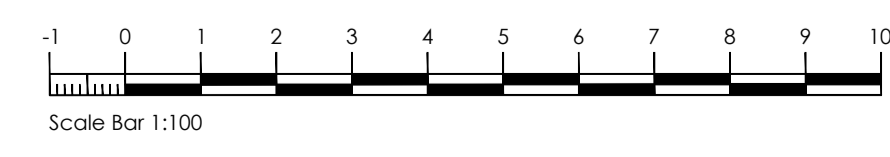
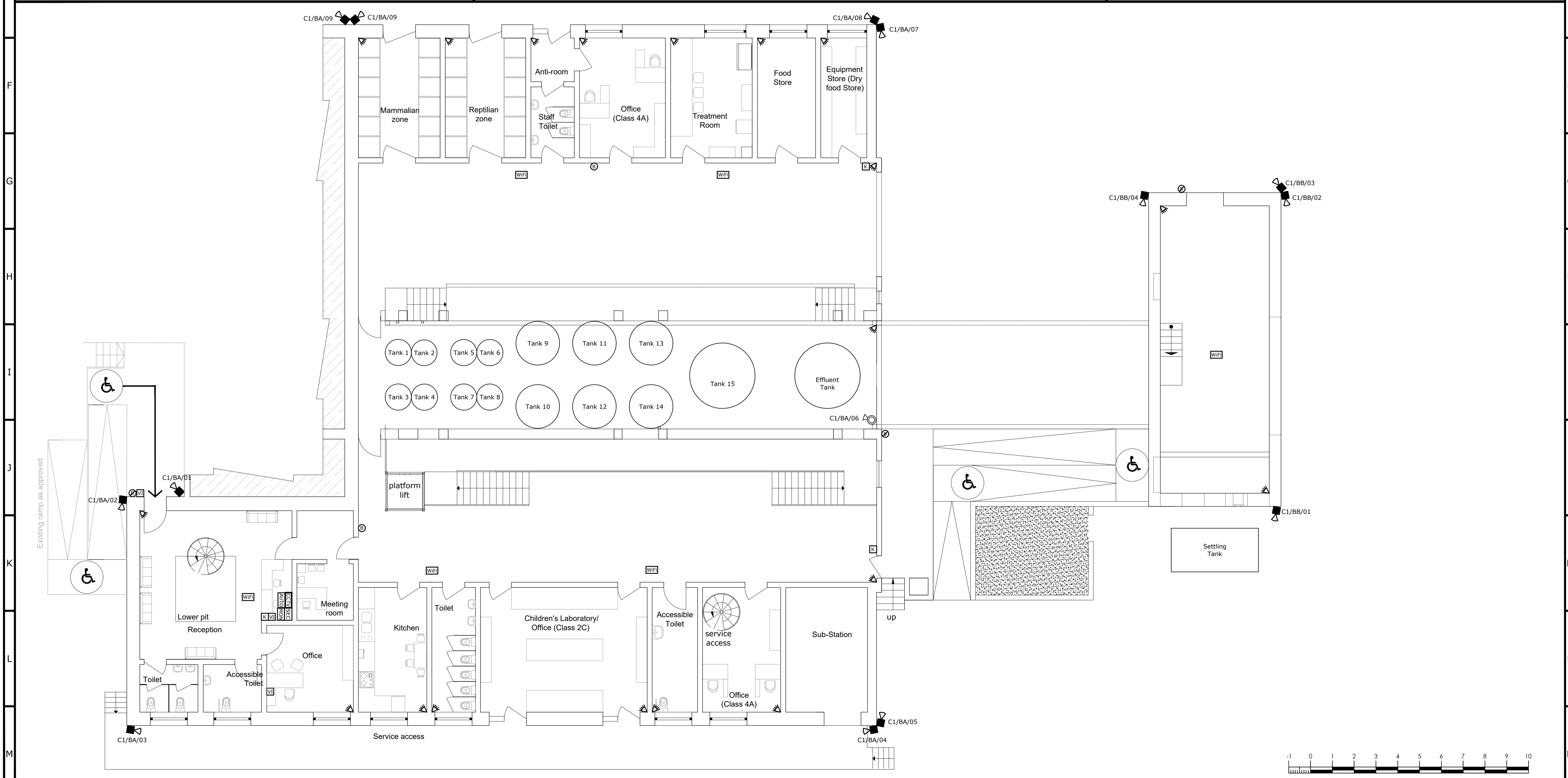

General Notes and Legends

Legend:-

- Dome Type Camera (POE)
- External Dome Type Camera (POE)
- External Type Camera (POE)
- Autodialler
- CCTV Multiplexer
- Security Monitor
- Telephone Point
- Video Intercom
- WiFi Point
- Beam Transmitter
- Beam Receiver
- Keypad
- 90° Presence Detector (Intruder)
- Internal Security Sounder
- External Security Sounder
- Perimeter Laser Detection
- Security Panel
- Access Control Type 01 - Online
- Access Control Type 02 - Escape Doors

C#/#/# Camera Reference No.

- General Note:**
- Exact Position and Orientation of cameras to be determined On Site with other Mechanical and Electrical services.
 - Video Interface panel located at main gate.

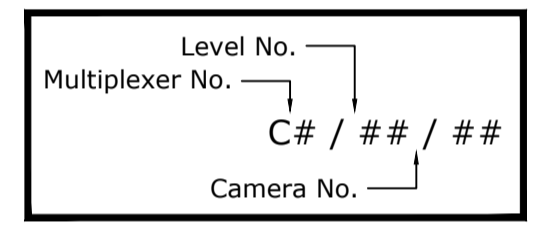

02	23.09.20	Revised	Revised Layout
01	14.09.20	Revised	Revised Layout

CAMILLERI & CUSCHIERI
CONSULTING ENGINEERS

Design Center, Level 2, Tower Road, Swatara,
Sirkikara, Malatya - 54120, Turkey
+356 21220431
info@camillerianduscieri.com
www.camillerianduscieri.com

40 Years

Project Name & Address:
Nature Trust
Xrobb L-Ghagin

THIS DRAWING IS CONFIDENTIAL AND IS THE PROPERTY OF CAMILLERI & CUSCHIERI CONSULTING ENGINEERS. IT MUST NOT BE DISCLOSED TO A THIRD PARTY, COPIED OR LENT, WITHOUT THE WRITTEN CONSENT OF CAMILLERI AND CUSCHIERI CONSULTING ENGINEERS.

Scale:	Revision No.:	Date:
1:100	02	01.09.20

Job No.:	Drawing No.:
20.032	NT-XG-ELV.01.01

Drawn By:	Checked By:
<i>Nayana Abida</i>	

Position:
Ground Floor

Service:
Extra Low Voltage Installation Layout

A1 PLEASE DO NOT SCALE FROM THE DRAWING