

Access to parking area

+0.00

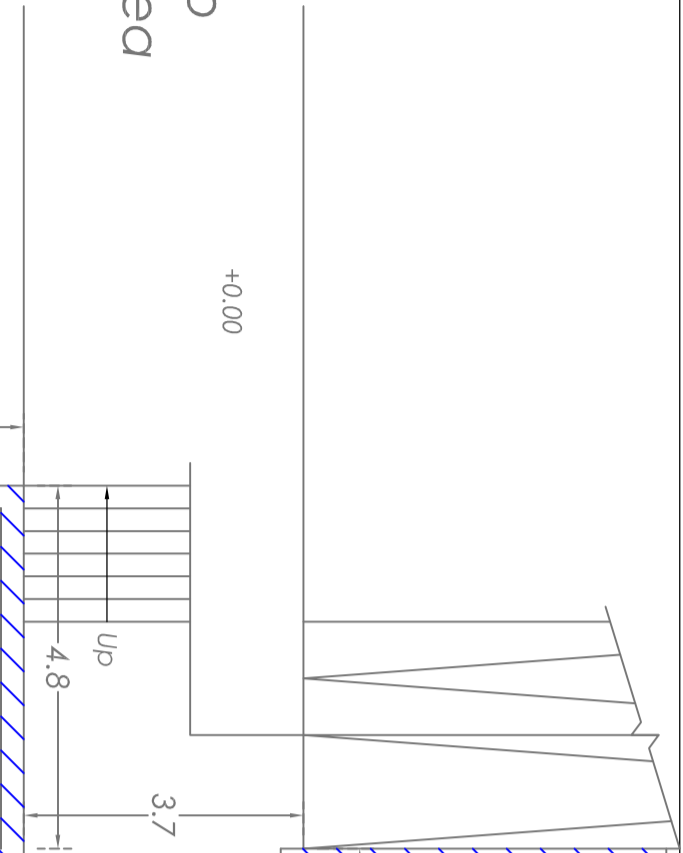

 230mm HCB (4 crs high)

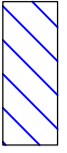
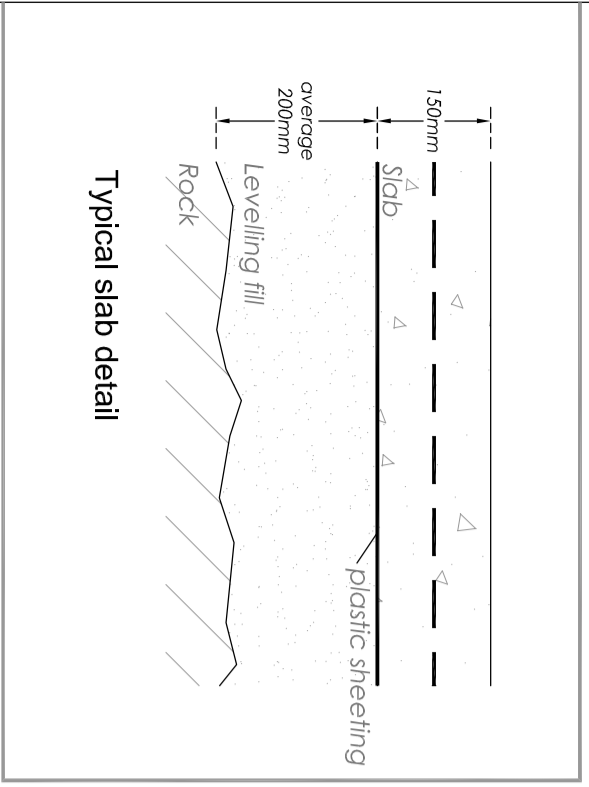

Typical slab detail

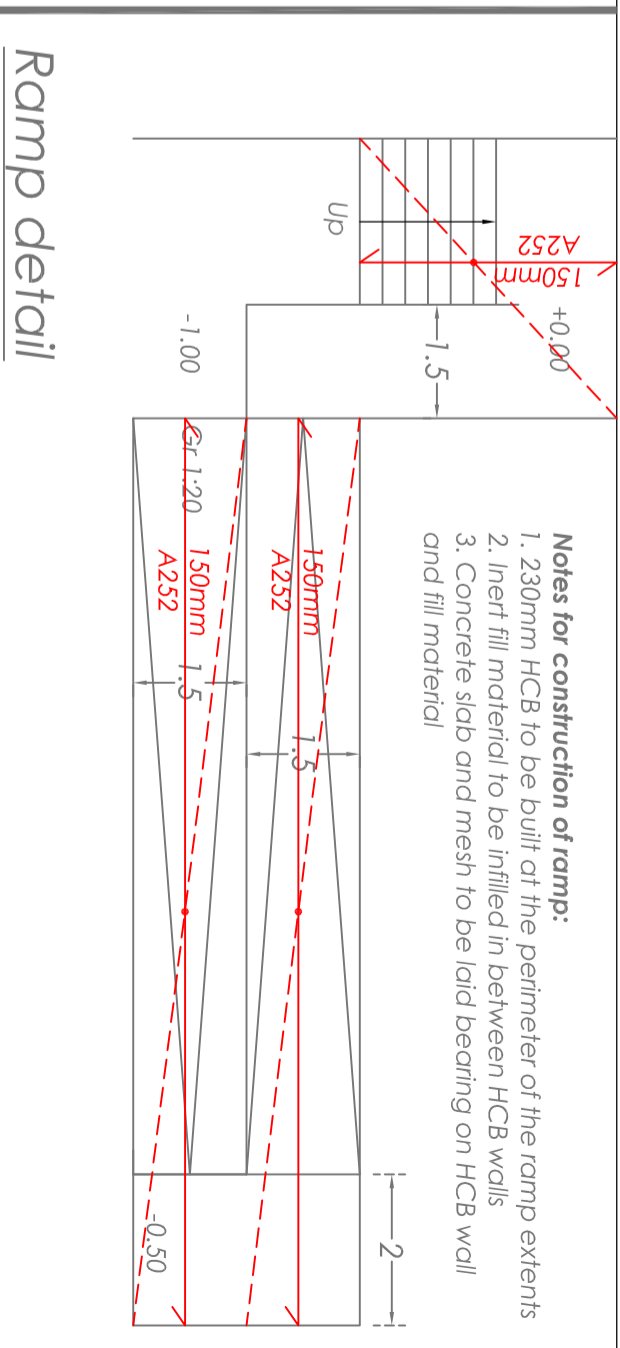
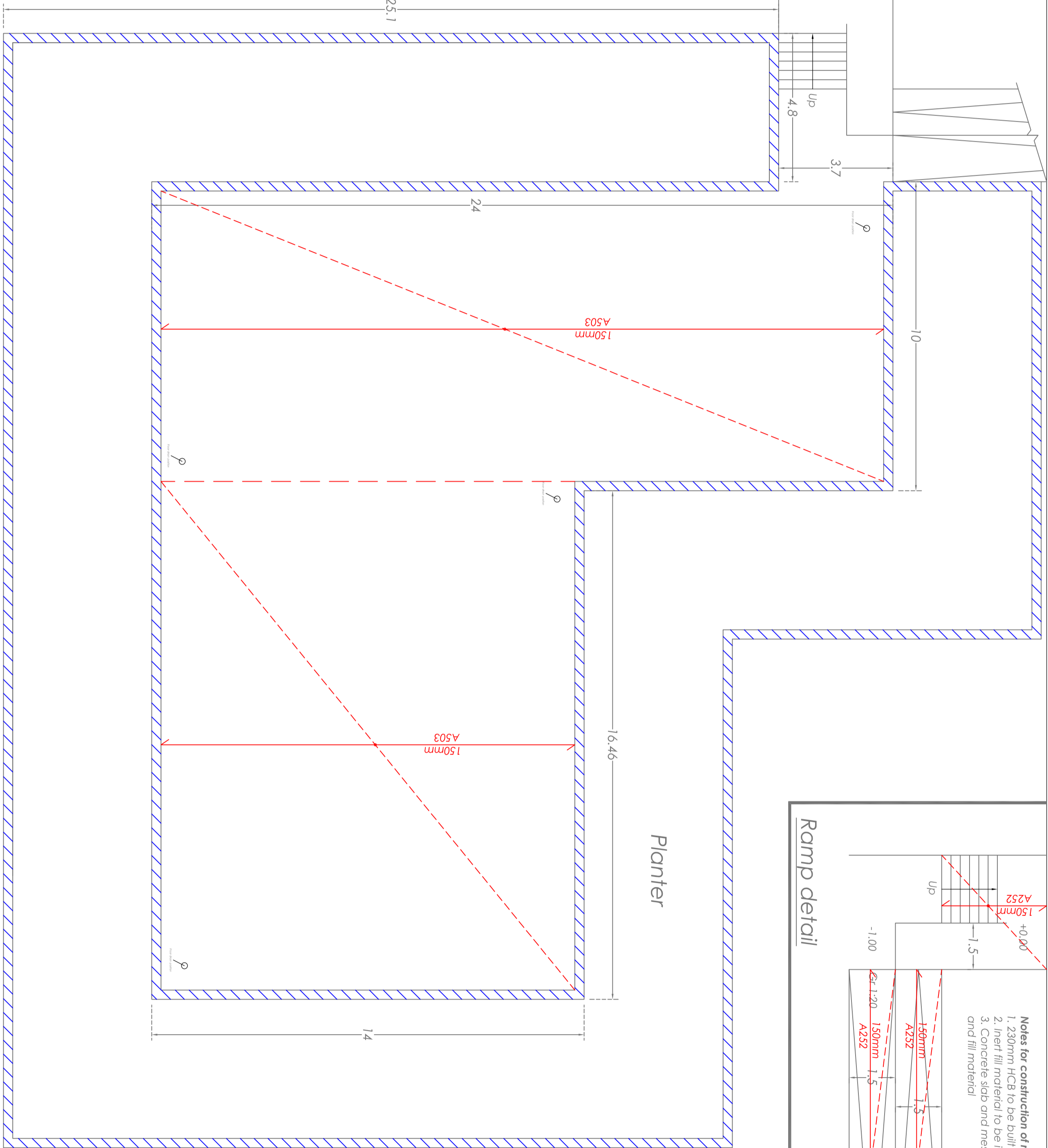

**Notes for construction of ramp:**  
 1. 230mm HCB to be built at the perimeter of the ramp extents  
 2. Inert fill material to be infilled in between HCB walls  
 3. Concrete slab and mesh to be laid bearing on HCB wall and fill material

**Notes:**

1. This drawing is to be read in conjunction with the other Architectural, Structural and Services drawings.
2. Do not scale off this drawing.
3. All dimensions are in metres
4. Unless otherwise specified, cover to all reinforcement above DPC level to be 30mm
5. Concrete grade to be C45/55, XS1, unless otherwise indicated.
6. Steel marked T to be high yield, minimum strength 460 MPa.
7. All laps to 40x bar diameter

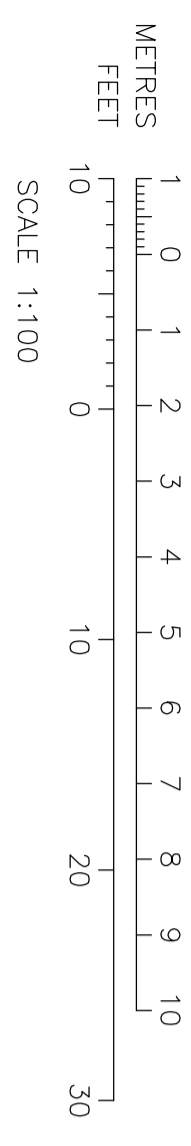

**Prof. Perit Ruben Paul Borg**

B.E.&A.(Hons.)(Melt.), Spec.Struct.Eng.(Millan), Ph.D.(Sheffield)  
 Eur.Eng., C.Eng, MICE, C.Env., MIED, MICT, MCS, MASCE, A.&C.E

Address:  
 25, TRIO LUIGI BILLION,  
 PEMBROKE PARK-1372  
 Tel: +356 21375245  
 E-Mail: ruben.pborg@gmail.com  
 Mob: +356 79055680

Project: Xrobb I-Ghagin  
 Project Ref. No.: 07.2015  
 Date: 20-03-2020

Drawing Title: Proposed Aviary Plan  
 Drawn By: OB  
 Checked By: RPB  
 Scale: 1:100 on A2  
 Dwg. No.: D13